

LEGEND

- EXISTING PROPERTY LINE
- - - EXISTING EASEMENT
- - - EXISTING GRADE MAJOR
- - - EXISTING GRADE MINOR
- x 542 EXISTING SPOT ELEVATION
- △ EXISTING WETLANDS LIMIT
- ⋯ APPROXIMATE SHORE LINE
- x - x - PROPOSED SILT FENCE
- ⊙ EXISTING SANITARY SEWER MANHOLE
- ⊙ EXISTING STORM SEWER
- ⊙ PROPOSED RAIN GARDEN
- ⊙ EXISTING UTILITY POLE
- ⊙ PERCOLATION TEST LOCATION
- ⊙ DEEP TEST PIT LOCATION

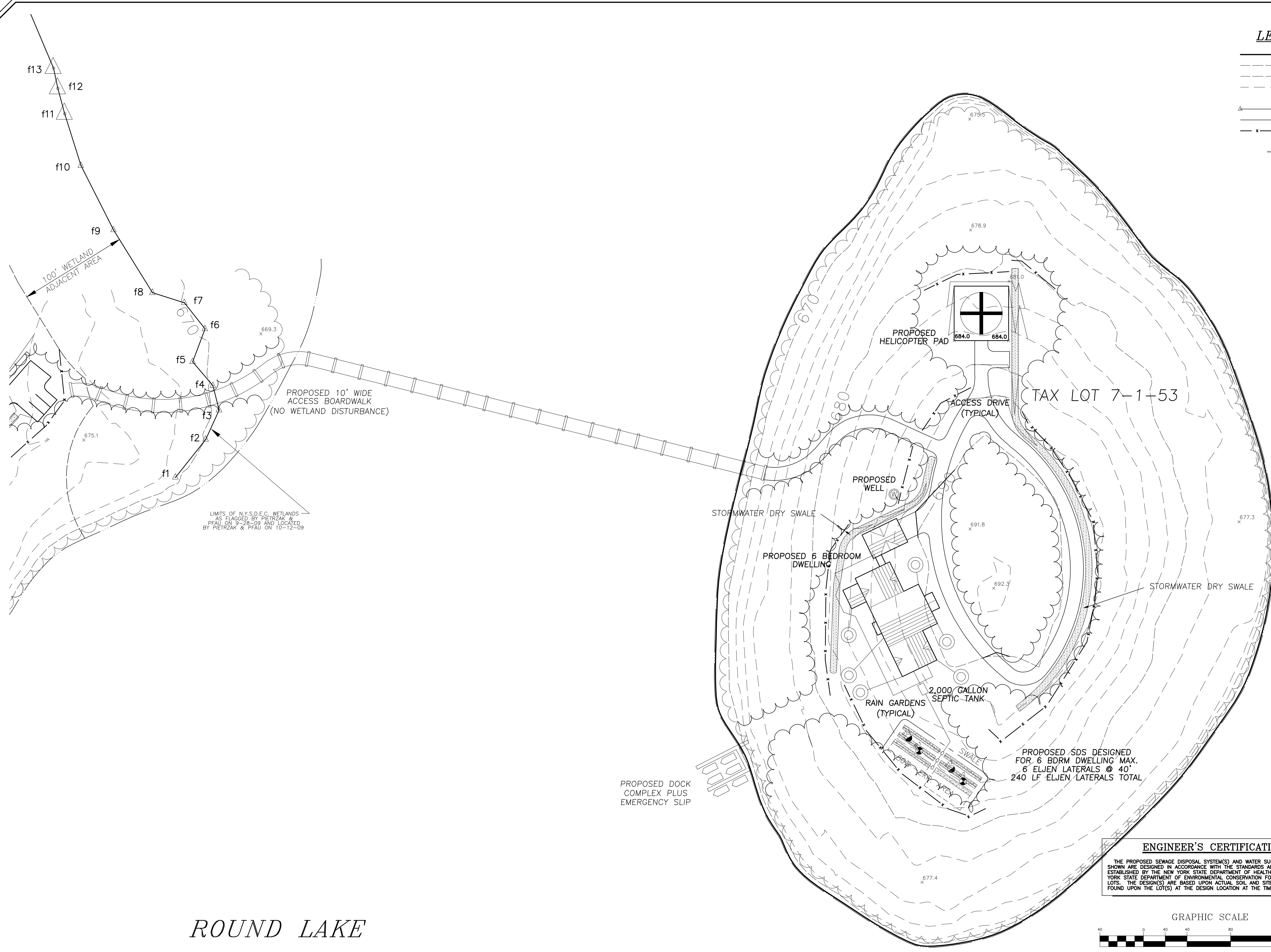
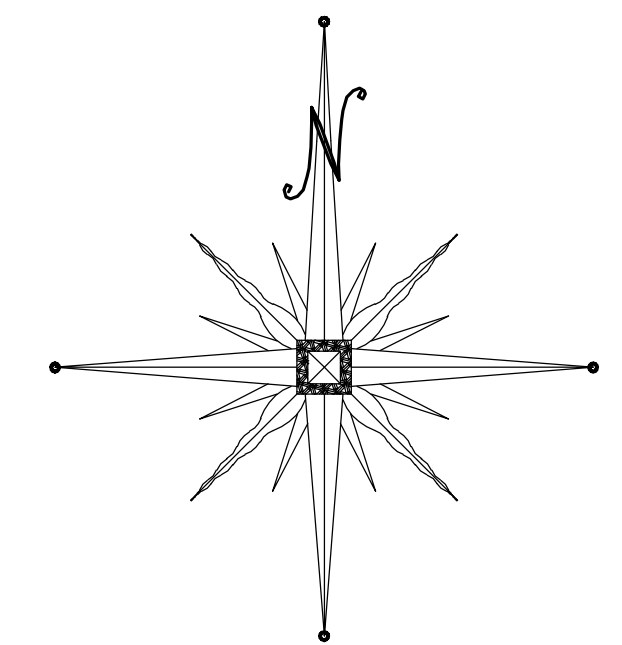

LIMITS OF N.Y.S.D.E.C. WETLANDS AS FLAGGED BY PIETRZAK & PFAU ON 9-28-09 AND LOCATED BY PIETRZAK & PFAU ON 10-12-09

PROPOSED 10' WIDE ACCESS BOARDWALK (NO WETLAND DISTURBANCE)

PROPOSED HELICOPTER PAD

ACCESS DRIVE (TYPICAL)

TAX LOT 7-1-53

PROPOSED WELL

STORMWATER DRY SWALE

PROPOSED 6 BEDROOM DWELLING

STORMWATER DRY SWALE

2,000 GALLON SEPTIC TANK

RAIN GARDENS (TYPICAL)

PROPOSED SDS DESIGNED FOR 6 BDRM DWELLING MAX. 6 ELJEN LATERALS @ 40' 240 LF ELJEN LATERALS TOTAL

PROPOSED DOCK COMPLEX PLUS EMERGENCY SLIP

ENGINEER'S CERTIFICATION

THE PROPOSED SEWAGE DISPOSAL SYSTEM(S) AND WATER SUPPLY SYSTEM(S) SHOWN ARE DESIGNED IN ACCORDANCE WITH THE STANDARDS AND REQUIREMENTS ESTABLISHED BY THE NEW YORK STATE DEPARTMENT OF HEALTH AND THE NEW YORK STATE DEPARTMENT OF ENVIRONMENTAL CONSERVATION FOR RESIDENTIAL LOTS. THE DESIGN(S) ARE BASED UPON ACTUAL SOIL AND SITE CONDITIONS FOUND UPON THE LOT(S) AT THE DESIGN LOCATION AT THE TIME OF DESIGN.

GRAPHIC SCALE

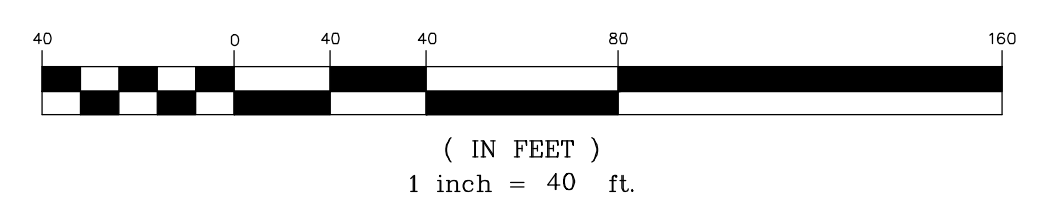

08/18/09	ORIGINAL PREPARATION DATE	JJP
DATE	DESCRIPTION	INITIALS
REVISIONS		
MAP CHECK DATE: 00/00/00	INITIALED BY: --	

PIETRZAK & PFAU
ENGINEERING & SURVEYING, PLLC

282 GREENWICH AVENUE, SUITE A GOSHEN, NEW YORK 10824 (845) 284-0808

2 HAMILTON AVENUE MONTICELLO, NEW YORK 12701 (845) 796-4946

MICHAEL P. CROGHAN P.L.S. LICENSE NO. 055823
ROBERT J. PFAU P.E. LICENSE NO. 088945

VINCENT A. PIETRZAK P.E. P.L.S. LICENSE NO. 076938
P.L.S. LICENSE NO. 050075
N.J.P.L.S. LICENSE NO. 33386

SIGNATURE _____ DATE _____

ROUND LAKE ISLAND

TOWN OF MONROE
COUNTY OF ORANGE, NEW YORK

PROJECT TITLE

SITE PLAN 2
SECTION 7, BLOCK 1, LOT 53

DRAWING TITLE

UNAUTHORIZED ALTERATION OR ADDITION TO A PLAN BEARING A LICENSED LAND SURVEYOR'S OR PROFESSIONAL ENGINEER'S SEAL IS A VIOLATION OF SECTION 7209, SUB-DIVISION 2 OF THE N.Y. STATE EDUCATION LAW.

O.C.H.D. SHEET NO	D.E.C. SHEET NO	DRAWING NUMBER
# OF #	# OF #	# OF #
SCALE	CAD REFERENCE	PROJECT NUMBER
1"=40'	2910701-SP1	29107.01

ROUND LAKE